

ATX™ JBEP Series FRP Terminal Junction Boxes for Electrical and Power Applications

Increased Safety. Factory Drilled and Equipped.

ATEX/IECEX: Zones 1 and 2 – 21 and 22
Notable: INMETRO Certified

Applications

- Electrical junction boxes are used to distribute power to lighting and to other power and control circuits.
- Power junction boxes are used to connect cables together to supply main lighting circuits, motors, service receptacles and other equipment.
- Designed for Zones 1 or 2 areas, where flammable gases or vapors are present either continuously, often or accidentally such as:
 - Petroleum
 - Chemical
 - Refineries
 - Other industrial process facilities
- Ideal for indoor/outdoor use with wet or corrosive atmospheres.
- Designed for use in Zones 21 or 22 areas where flammable dusts (conductive and non conductive) are present either continuously, often or accidentally such as:
 - Food processing
 - Dairy
 - Brewing
 - Other industrial process facilities



Cable glands are available as an option.

Features

- Available in multiple terminal configurations.
- Supplied with terminals Size 2.5 mm² (14AWG) through 120 mm² (250MCM).

Standard materials

- Enclosures: Static resistant carbon filled fiberglass reinforced polyester (FRP)
- Hardware: stainless steel

Options

- Nameplates
- Mounting pan
- Inside pocket for document
- Consult factory for custom drilling, assembly requirements and other ambient temperatures.

ATEX/IECEX Certifications and Compliances ①

- Certification Type: JBEP
 - Gas, Zones 1 and 2:
 - Conforming to ATEX 2014/34/EU: Ⓢ II 2G
 - Conforming to IECEX: EPL Gb
 - Type of Protection: Ex eb IIC / Ex eb ia IIC / Ex eb ib IIC / Ex ia ou ib IIC Gb
 - Temperature Class: T6 for Ta -60 °C (-76 °F) +55 °C (+131 °F)
 - Dusts, Zones 21 and 22:
 - Conforming to ATEX 2014/34/EU: Ⓢ II 2D
 - Conforming to IECEX: EPL Db
 - Type of Protection: Ex tb IIIC
 - Surface Temperature : T75 °C (T167 °F) for Ta ≤ +55 °C (+131 °F)
- Ambient Temperatures: -60 °C ≤ Ta ≤ +55 °C (-76 °F ≤ Ta ≤ +131 °F)
- ATEX Certificate : LCIE 12 ATEX 3037X
- EC Declaration of Conformity : 50291
- IECEX Certificate : IECEX LCIE 13.0003X
- Index of Protection according EN/IEC 60529: IP66
- Impact Resistance (shock): IK10

INMETRO Certifications

- INMETRO Certificate: BVC 13.3238-X

① The ambient temperature for complete assembly is equal to the lowest ambient temperature of the components used.

ATX™ JBEP Series FRP Terminal Junction Boxes for Electrical and Power Applications

Increased Safety. Factory Drilled and Equipped.

ATEX/IECEX: Zones 1 and 2 – 21 and 22
 Notable: INMETRO Certified

Enclosures and Junction Boxes

Illustrated Features — Sample of JBEP080806NE04T

Description

- | | |
|----|--|
| 1 | Screw M5 x 6 mm (M5 x 0.24 in) |
| 2 | JBEP0808060 - Base Holes: 3 x Ø 20.5 mm (3 x Ø 0.81 in) |
| 3 | Cover Of Polyester Box Type 85 x 85 x 60 mm (3.35 x 3.35 x 2.36 in) |
| 4 | Hood Terminals Compact Set |
| 8 | Nameplate |
| 9 | Gasket Box Type 85 x 85 x 60 mm (3.35 x 3.35 x 2.36 in) |
| 10 | Compact set of well connection terminals. Screw M4 x 7 mm (M4 x 0.28 in) |
| 11 | Entry Thread Seal M20 |
| 12 | Nickel-Plated Brass Locknuts M20 x 1.5 mm (M20 x 0.06 in) |
| 13 | EEx e M20 Cable Gland |
| 15 | Cover Screw M6 x 20 x 10 mm (M6 x 0.79 x 100.39 in) |
| 16 | Hood Term Cover |
| 17 | Earth Plate |

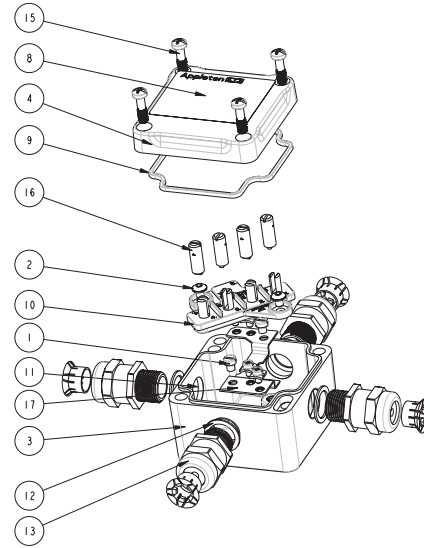

The Catalog Numbering Guide is a reference tool to explain the make-up of the catalog number. It is not to be used to create a custom product for ordering.

Catalog Numbering Guide - JBEP Polyester Junction Boxes for Electrical and Power Applications

JBE Series: JBE - NEC/CEC and ATEX/ IECEX Certified Junction Box	P Material: P - Polyester	08 Height Dimensions mm (in): 08 - 85 (3.35) 12 - 120 (4.72) 17 - 170 (6.69) 20 - 200 (7.87) 25 - 250 (9.84) 32 - 320 (12.60) 50 - 500 (19.69) 75 - 750 (29.53)	08 Width Dimensions mm (in): 08 - 85 (3.35) 12 - 120 (4.72) 17 - 170 (6.69) 21 - 215 (8.47) 25 - 250 (9.84) 32 - 320 (12.60) 50 - 500 (19.69) 75 - 750 (29.53)	06 Depth Dimensions mm (in): 06 - 60 (2.36) 09 - 91 (3.58) 10 - 95 (3.74) 15 - 150 (5.91) 23 - 230 (9.06)	A Cable Type: A - Armored N - Non-Armored	E Options: <i>(Options must be listed alphabetically)</i> E - Electrical: 2.5 mm ² (14AWG) x 10 mm ² (6AWG) P - Power: 16 mm ² (6AWG) to 240 mm ² (474MCM)	01 Suffix: 01 to 99 <i>Assigned at Factory</i>	T Other Suffix: T - Mantle Clamping (Pillar Terminals)
---	--	--	---	---	---	--	--	--

ATX™ JBEP Series FRP Terminal Junction Boxes for Electrical and Power Applications

Increased Safety. Factory Drilled and Equipped.

ATEX/IECEx: Zones 1 and 2 – 21 and 22
 Notable: INMETRO Certified



JBEP080806NE04T

Ex eb IIC Factory Drilled JBEP Polyester Junction Boxes Equipped with 4 Live Mantle Clamping (Pillar Terminals) and 1 Earth Terminal Per Way

Maximum capacity per terminal:

- 4 x 2.5 mm² or 2 x 4 mm² + 2 x 2.5 mm², 550 Volts

Maximum capacity per earth terminal:

- 1 x 4 mm²

Rating (Amps):

- 22 Amps maximum for 4 mm²

Enclosure Type	Equipment	Entry Layout	Weight kg (lb)	Volume dm ³ (in ³)	Dimensions - mm (in)	Catalog Number
JBEP0808060	3 x M20 with earth continuity sheet		0.42 (0.93)	0.44 (26.9)	85 x 85 x 61 (3.35 x 3.35 x 2.40)	JBEP080806AE03T
JBEP0808060	3 x M20 with three cable glands for unarmored cable Diameter 6.5 to 14.5 mm (0.26 to 0.57 in)		0.45 (0.99)	0.44 (26.9)	85 x 85 x 61 (3.35 x 3.35 x 2.40)	JBEP080806NE03T
JBEP0808060	4 x M20 with earth continuity sheet		0.43 (0.95)	0.44 (26.9)	85 x 85 x 61 (3.35 x 3.35 x 2.40)	JBEP080806AE04T
JBEP0808060	4 x M20 with four cable glands for unarmored cable Diameter 6.5 to 14.5 mm (0.26 to 0.57 in)		0.48 (1.06)	0.44 (26.9)	85 x 85 x 61 (3.35 x 3.35 x 2.40)	JBEP080806NE04T

Ex eb IIC Factory Drilled JBEP Polyester Junction Boxes Equipped with 5 Live Mantle Clamping (Pillar Terminals) and 1 Earth Terminal Per Way

Maximum capacity per terminal:

- 3 x 6 mm² or 4 x 4 mm² or 2 x 6 mm² + 2 x 4 mm², 690 Volts

Maximum capacity per earth terminal:

- 1 x 6 mm²

Rating (Amps):

- 27 Amps maximum for 6 mm²

Enclosure Type	Equipment	Entry Layout	Weight kg (lb)	Volume dm ³ (in ³)	Dimensions - mm (in)	Catalog Number
JBEP121209S0	3 x M20 with earth continuity sheet		0.85 (1.87)	1.31 (80.0)	120 x 120 x 91 (4.72 x 4.72 x 3.58)	JBEP121209AE03T
JBEP121209S0	3 x M25 with three cable glands for unarmored cable Diameter 8 to 17 mm (0.31 to 0.67 in) ②		0.9 (1.98)	1.31 (80.0)	120 x 120 x 91 (4.72 x 4.72 x 3.58)	JBEP121209NE13T
JBEP121209S0	4 x M20 with earth continuity sheet		0.88 (1.94)	1.31 (80.0)	120 x 120 x 91 (4.72 x 4.72 x 3.58)	JBEP121209AE04T
JBEP121209S0	4 x M25 with four cable glands for unarmored cable Diameter 8 to 17 mm (0.31 to 0.67 in) ②		0.95 (2.09)	1.31 (80.0)	120 x 120 x 91 (4.72 x 4.72 x 3.58)	JBEP121209NE14T

ATX™ JBEP Series FRP Terminal Junction Boxes for Electrical and Power Applications

Increased Safety. Factory Drilled and Equipped.

ATEX/IECEX: Zones 1 and 2 – 21 and 22
 Notable: INMETRO Certified

Ex eb IIC Factory Drilled JBEP Polyester Junction Boxes Equipped with 8 Live Mantle Clamping (Pillar Terminals) and 1 Earth Terminal Per Way

Maximum capacity per terminal:



- 3 x 6 mm² or 4 x 4 mm² or 2 x 6 mm²+ 2 x 4 mm², 690 Volts

Maximum capacity per earth terminal:

- 1 x 6 mm²

Rating (Amps):

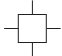
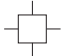
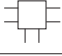
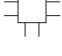
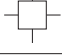
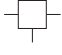
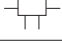
- 24 Amps maximum for 6 mm²

Enclosure Type	Equipment	Entry Layout	Weight kg (lb)	Volume dm ³ (in ³)	Dimensions - mm (in)	Catalog Number
JBEP1717090	4 x M20 with earth continuity sheet		1.63 (3.59)	8.91 x 108 (54.3)	170 x 170 x 91 (6.69 x 6.69 x 3.58)	JBEP171709AE04T
JBEP1717090	4 x M20 with three cable glands for unarmored cable Diameter 6.5 to 14.5 mm (0.26 to 0.57 in)		1.55 (3.42)	8.91 x 108 (54.3)	170 x 170 x 91 (6.69 x 6.69 x 3.58)	JBEP171709NE04T
JBEP1717090	6 x M20 with earth continuity sheet		1.55 (3.42)	8.91 x 108 (54.3)	170 x 170 x 91 (6.69 x 6.69 x 3.58)	JBEP171709AE06T
JBEP1717090	6 x M20 with three cable glands for unarmored cable Diameter 6.5 to 14.5 mm (0.26 to 0.57 in)		1.65 (3.64)	8.91 x 108 (54.3)	170 x 170 x 91 (6.69 x 6.69 x 3.58)	JBEP171709NE06T
JBEP1717090	4 x M25 with earth continuity sheet		1.62 (3.57)	8.91 x 108 (54.3)	170 x 170 x 91 (6.69 x 6.69 x 3.58)	JBEP171709AE14T
JBEP1717090	4 x M25 with four cable glands for unarmored cable Diameter 8 to 17 mm (0.31 to 0.67 in)		1.60 (3.53)	8.91 x 108 (54.3)	170 x 170 x 91 (6.69 x 6.69 x 3.58)	JBEP171709NE14T
JBEP1717090	6 x M25 with earth continuity sheet		1.55 (3.42)	8.91 x 108 (54.3)	170 x 170 x 91 (6.69 x 6.69 x 3.58)	JBEP171709AE16T
JBEP1717090	6 x M25 with four cable glands for unarmored cable Diameter 8 to 17 mm (0.31 to 0.67 in)		1.65 (3.64)	8.91 x 108 (54.3)	170 x 170 x 91 (6.69 x 6.69 x 3.58)	JBEP171709NE16T

ATX™ JBEP Series FRP Terminal Junction Boxes for Electrical and Power Applications

Increased Safety. Factory Drilled and Equipped.

ATEX/IECEx: Zones 1 and 2 – 21 and 22
 Notable: INMETRO Certified

Ex eb IIC Factory Drilled JBEP Polyester Junction Boxes Equipped with 4 Screw Terminals and 2 Earth Terminals

• 2 x 6 mm² terminals (WDU6), Rating 22 Amps for 6 mm², 19 Amps for 4 mm², 440 Volts

Enclosure Type	Equipment	Entry Layout	Weight kg (lb)	Volume dm ³ (in ³)	Dimensions - mm (in)	Terminal Jumped Catalog Number
Configuration: P + N (1PE + 2L + 2N + 1PE)						
JBEP121209S0	4 x M20 with earth continuity device		1.00 (2.20)	1.31 (80.0)	120 x 120 x 91 (4.72 x 4.72 x 3.58)	JBEP121209AE45
JBEP121209S0	4 x M25 with four cable glands for unarmored cable Diameter 8 to 17 mm (0.31 to 0.67 in)		1.00 (2.20)	1.31 (80.0)	120 x 120 x 91 (4.72 x 4.72 x 3.58)	JBEP121209NE46
JBEP121209S0	4 x M20 with earth continuity device		0.96 (2.12)	1.31 (80.0)	120 x 120 x 91 (4.72 x 4.72 x 3.58)	JBEP121209AE47
JBEP121209S0	4 x M25 with four cable glands for unarmored cable Diameter 8 to 17 mm (0.31 to 0.67 in)		1.00 (2.20)	1.31 (80.0)	120 x 120 x 91 (4.72 x 4.72 x 3.58)	JBEP121209NE48

Enclosures and Junction Boxes

ATX™ JBEP Series FRP Terminal Junction Boxes for Electrical and Power Applications

Increased Safety. Factory Drilled and Equipped.

ATEX/IECEx: Zones 1 and 2 – 21 and 22
 Notable: INMETRO Certified

Ex eb IIC Factory Drilled JBEP Polyester Junction Boxes Equipped with 12 Screw Terminals and 3 Earth Terminals

• 2 x 4 mm² terminals (WDU4), Rating 17 Amps for 4 mm², 14 Amps for 2.5 mm², 550 Volts

Enclosure Type	Equipment	Entry Layout	Weight kg (lb)	Volume dm ³ (in ³)	Dimensions - mm (in)	Terminal Jumped Catalog Number
Configuration: TP + N (1PE + 3L1 + 3L2 + 3L3 + 3N + 2PE)						
JBEP1717090	4 x M25 with earth continuity device		1.54 (3.40)	2.63 (160.49)	170 x 170 x 91 (6.69 x 6.69 x 3.58)	JBEP171709AE46
JBEP1717090	4 x M25 with four cable glands for unarmored cable Diameter 8 to 17 mm (0.31 to 0.67 in)		1.54 (3.40)	2.63 (160.49)	170 x 170 x 91 (6.69 x 6.69 x 3.58)	JBEP171709NE46
JBEP1717090	6 x M20 with earth continuity device		1.54 (3.40)	2.63 (160.49)	170 x 170 x 91 (6.69 x 6.69 x 3.58)	JBEP171709AE47
JBEP1717090	6 x M20 with four cable glands for unarmored cable Diameter 6.5 to 14.5 mm (0.26 to 0.57 in)		1.54 (3.40)	2.63 (160.49)	170 x 170 x 91 (6.69 x 6.69 x 3.58)	JBEP171709NE47
JBEP1717090	6 x M25 with earth continuity device		1.54 (3.40)	2.63 (160.49)	170 x 170 x 91 (6.69 x 6.69 x 3.58)	JBEP171709AE48
JBEP1717090	6 x M25 with four cable glands for unarmored cable Diameter 8 to 17 mm (0.31 to 0.67 in)		1.54 (3.40)	2.63 (160.49)	170 x 170 x 91 (6.69 x 6.69 x 3.58)	JBEP171709NE48

Enclosures and Junction Boxes

ATX™ JBEP Series FRP Terminal Junction Boxes for Electrical and Power Applications

Increased Safety. Factory Drilled and Equipped.

ATEX/IECEX: Zones 1 and 2 – 21 and 22
 Notable: INMETRO Certified



JBEP171709AE06

Ex eb IIC Factory Drilled JBEP Polyester Junction Boxes Equipped with Screw Terminals and Earth Terminals

- 6 mm² terminals (WDU6) and earth terminals (WPE6), 22 Amps maximum for 6 mm² and 4 mm², 440 Volts

Enclosure Type	Equipment	Entry Layout	Weight kg (lb)	Volume dm ³ (in ³)	Dimensions - mm (in)	Terminal Jumped Catalog Number
Configuration: P + N (1PE + 2L + 2N + 1PE)						
JBEP1717090	3 x M20 with earth continuity device		1.54 (3.40)	2.63 (160.49)	170 x 170 x 91 (6.69 x 6.69 x 3.58)	JBEP171709AE01
JBEP1717090	3 x M25 with three cable glands for unarmored cable Diameter 8 to 17 mm (0.31 to 0.67 in)		1.54 (3.40)	2.63 (160.49)	170 x 170 x 91 (6.69 x 6.69 x 3.58)	JBEP171709NE01
JBEP1717090	4 x M20 with earth continuity device		1.54 (3.40)	2.63 (160.49)	170 x 170 x 91 (6.69 x 6.69 x 3.58)	JBEP171709AE02
JBEP1717090	4 x M25 with four cable glands for unarmored cable Diameter 8 to 17 mm (0.31 to 0.67 in)		1.54 (3.40)	2.63 (160.49)	170 x 170 x 91 (6.69 x 6.69 x 3.58)	JBEP171709NE02
JBEP1717090	4 x M20 with earth continuity device		1.54 (3.40)	2.63 (160.49)	170 x 170 x 91 (6.69 x 6.69 x 3.58)	JBEP171709AE03
JBEP1717090	4 x M25 with four cable glands for unarmored cable Diameter 8 to 17 mm (0.31 to 0.67 in)		1.54 (3.40)	2.63 (160.49)	170 x 170 x 91 (6.69 x 6.69 x 3.58)	JBEP171709NE03
Configuration: P + N (1PE + 3L + 3N + 2PE)						
JBEP1717090	6 x M20 with earth continuity device		1.54 (3.40)	2.63 (160.49)	170 x 170 x 91 (6.69 x 6.69 x 3.58)	JBEP171709AE04
JBEP1717090	6 x M25 with six cable glands for unarmored cable Diameter 8 to 17 mm (0.31 to 0.67 in)		1.54 (3.40)	2.63 (160.49)	170 x 170 x 91 (6.69 x 6.69 x 3.58)	JBEP171709NE04
Configuration: TP (1PE + 2L1 + 2L2 + 2L3 + 1PE)						
JBEP1717090	3 x M20 with earth continuity device		1.54 (3.40)	2.63 (160.49)	170 x 170 x 91 (6.69 x 6.69 x 3.58)	JBEP171709AE05
JBEP1717090	3 x M25 with three cable glands for unarmored cable Diameter 8 to 17 mm (0.31 to 0.67 in)		1.54 (3.40)	2.63 (160.49)	170 x 170 x 91 (6.69 x 6.69 x 3.58)	JBEP171709NE05
JBEP1717090	4 x M20 with earth continuity device		1.54 (3.40)	2.63 (160.49)	170 x 170 x 91 (6.69 x 6.69 x 3.58)	JBEP171709AE06
JBEP1717090	4 x M25 with four cable glands for unarmored cable Diameter 8 to 17 mm (0.31 to 0.67 in)		1.54 (3.40)	2.63 (160.49)	170 x 170 x 91 (6.69 x 6.69 x 3.58)	JBEP171709NE06
JBEP1717090	4 x M20 with earth continuity device		1.54 (3.40)	2.63 (160.49)	170 x 170 x 91 (6.69 x 6.69 x 3.58)	JBEP171709AE07
JBEP1717090	4 x M25 with four cable glands for unarmored cable Diameter 8 to 17 mm (0.31 to 0.67 in)		1.54 (3.40)	2.63 (160.49)	170 x 170 x 91 (6.69 x 6.69 x 3.58)	JBEP171709NE07

Enclosures and Junction Boxes

ATX™ JBEP Series FRP Terminal Junction Boxes for Electrical and Power Applications

Increased Safety. Factory Drilled and Equipped.

ATEX/IECEX: Zones 1 and 2 – 21 and 22
 Notable: INMETRO Certified



JBEP171709AE10

Ex eb IIC Factory Drilled JBEP Polyester Junction Boxes Equipped with Screw Terminals and Earth Terminals

- 6 mm² terminals (WDU6) and earth terminals (WPE6)

Enclosure Type	Equipment	Entry Layout	Weight kg (lb)	Volume dm ³ (in ³)	Dimensions - mm (in)	Terminal Jumped
						Catalog Number
Configuration: TP (2PE + 3L1 + 3L2 + 3L3 + 1PE) • 22 Amps maximum for 6 mm ² , 20 Amps maximum for 4 mm ² , 440 Volts						
JBEP1717090	6 x M20 with earth continuity device		1.54 (3.40)	2.63 (160.49)	170 x 170 x 91 (6.69 x 6.69 x 3.58)	JBEP171709AE08
JBEP1717090	6 x M25 with six cable glands for unarmored cable Diameter 8 to 17 mm (0.31 to 0.67 in)		1.54 (3.40)	2.63 (160.49)	170 x 170 x 91 (6.69 x 6.69 x 3.58)	JBEP171709NE08
Configuration: TP + N (2PE + 2L1 + 2L2 + 2L3 + 2N + 1PE) • 22 Amps maximum for 6 mm ² , 21 Amps maximum for 4 mm ² , 440 Volts						
JBEP1717090	3 x M20 with earth continuity device		1.54 (3.40)	2.63 (160.49)	170 x 170 x 91 (6.69 x 6.69 x 3.58)	JBEP171709AE09
JBEP1717090	3 x M25 with three cable glands for unarmored cable Diameter 8 to 17 mm (0.31 to 0.67 in)		1.54 (3.40)	2.63 (160.49)	170 x 170 x 91 (6.69 x 6.69 x 3.58)	JBEP171709NE09
JBEP1717090	4 x M20 with earth continuity device		1.54 (3.40)	2.63 (160.49)	170 x 170 x 91 (6.69 x 6.69 x 3.58)	JBEP171709AE10
JBEP1717090	4 x M25 with four cable glands for unarmored cable Diameter 8 to 17 mm (0.31 to 0.67 in)		1.54 (3.40)	2.63 (160.49)	170 x 170 x 91 (6.69 x 6.69 x 3.58)	JBEP171709NE10
JBEP1717090	4 x M20 with earth continuity device		1.54 (3.40)	2.63 (160.49)	170 x 170 x 91 (6.69 x 6.69 x 3.58)	JBEP171709AE11
JBEP1717090	4 x M25 with four cable glands for unarmored cable Diameter 8 to 17 mm (0.31 to 0.67 in)		1.54 (3.40)	2.63 (160.49)	170 x 170 x 91 (6.69 x 6.69 x 3.58)	JBEP171709NE11
Configuration: TP + N (2PE + 3L1 + 3L2 + 3L3 + 3N + 1PE) • 21 Amps maximum for 6 mm ² , 17 Amps maximum for 4 mm ² , 440 Volts						
JBEP2021100	6 x M20 with earth continuity device		2.04 (4.50)	4.09 (249.28)	200 x 215 x 95 (7.87 x 8.46 x 3.74)	JBEP202110AE12
JBEP2021100	6 x M25 with six cable glands for unarmored cable Diameter 8 to 17 mm (0.31 to 0.67 in)		2.04 (4.50)	4.09 (249.28)	200 x 215 x 95 (7.87 x 8.46 x 3.74)	JBEP202110NE12

ATX™ JBEP Series FRP Terminal Junction Boxes for Electrical and Power Applications

Increased Safety. Factory Drilled and Equipped.

ATEX/IECEx: Zones 1 and 2 – 21 and 22
 Notable: INMETRO Certified



JBEP171709NE52

Ex eb IIC Factory Drilled JBEP Polyester Junction Boxes Equipped with Screw Terminals and Earth Terminals

- 10 mm² terminals (WDU10) and earth terminals (WPE10), 30 Amps maximum for 10 mm² and 6 mm², 440 Volts

Enclosure Type	Equipment	Entry Layout	Weight kg (lb)	Volume dm ³ (in ³)	Dimensions - mm (in)	Terminal Jumped Catalog Number
Configuration: P + N (1PE + 2L + 2N + 1PE)						
JBEP1717090	3 x M20 with earth continuity device		2.04 (4.50)	2.63 (160.49)	170 x 170 x 91 (6.69 x 6.69 x 3.58)	JBEP171709AE51
JBEP1717090	3 x M25 with three cable glands for unarmored cable Diameter 8 to 17 mm (0.31 to 0.67 in)		2.04 (4.50)	2.63 (160.49)	170 x 170 x 91 (6.69 x 6.69 x 3.58)	JBEP171709NE51
JBEP1717090	4 x M20 with earth continuity device		2.04 (4.50)	2.63 (160.49)	170 x 170 x 91 (6.69 x 6.69 x 3.58)	JBEP171709AE52
JBEP1717090	4 x M25 with four cable glands for unarmored cable Diameter 8 to 17 mm (0.31 to 0.67 in)		2.04 (4.50)	2.63 (160.49)	170 x 170 x 91 (6.69 x 6.69 x 3.58)	JBEP171709NE52
JBEP1717090	4 x M20 with earth continuity device		2.04 (4.50)	2.63 (160.49)	170 x 170 x 91 (6.69 x 6.69 x 3.58)	JBEP171709AE53
JBEP1717090	4 x M25 with four cable glands for unarmored cable Diameter 8 to 17 mm (0.31 to 0.67 in)		2.04 (4.50)	2.63 (160.49)	170 x 170 x 91 (6.69 x 6.69 x 3.58)	JBEP171709NE53

Enclosures and Junction Boxes

ATX™ JBEP Series FRP Terminal Junction Boxes for Electrical and Power Applications

Increased Safety. Factory Drilled and Equipped.

ATEX/IECEx: Zones 1 and 2 – 21 and 22
 Notable: INMETRO Certified



JBEP171709AE57

Ex eb IIC Factory Drilled JBEP Polyester Junction Boxes Equipped with Screw Terminals and Earth Terminals

- 10 mm² terminals (WDU10) and earth terminals (WPE10), 30 Amps maximum for 10 mm² and 6 mm², 440 Volts

Enclosure Type	Equipment	Entry Layout	Weight kg (lb)	Volume dm ³ (in ³)	Dimensions - mm (in)	Terminal Jumped Catalog Number
Configuration: P + N (2PE + 3L + 3N + 1PE)						
JBEP1717090	6 x M20 with earth continuity device		2.04 (4.50)	2.63 (160.49)	170 x 170 x 91 (6.69 x 6.69 x 3.58)	JBEP171709AE54
JBEP1717090	6 x M25 with six cable glands for unarmored cable Diameter 8 to 17 mm (0.31 to 0.67 in)		2.04 (4.50)	2.63 (160.49)	170 x 170 x 91 (6.69 x 6.69 x 3.58)	JBEP171709NE54
Configuration: TP (1PE + 2L1 + 2L2 + 2L3 + 1PE)						
JBEP1717090	3 x M25 with earth continuity device		2.04 (4.50)	2.63 (160.49)	170 x 170 x 91 (6.69 x 6.69 x 3.58)	JBEP171709AE55
JBEP1717090	3 x M25 with three cable glands for unarmored cable Diameter 8 to 17 mm (0.31 to 0.67 in)		2.04 (4.50)	2.63 (160.49)	170 x 170 x 91 (6.69 x 6.69 x 3.58)	JBEP171709NE55
JBEP1717090	4 x M25 with earth continuity device		2.04 (4.50)	2.63 (160.49)	170 x 170 x 91 (6.69 x 6.69 x 3.58)	JBEP171709AE56
JBEP1717090	4 x M25 with four cable glands for unarmored cable Diameter 8 to 17 mm (0.31 to 0.67 in)		2.04 (4.50)	2.63 (160.49)	170 x 170 x 91 (6.69 x 6.69 x 3.58)	JBEP171709NE56
JBEP1717090	4 x M25 with earth continuity device		2.04 (4.50)	2.63 (160.49)	170 x 170 x 91 (6.69 x 6.69 x 3.58)	JBEP171709AE57
JBEP1717090	4 x M25 with four cable glands for unarmored cable Diameter 8 to 17 mm (0.31 to 0.67 in)		2.04 (4.50)	2.63 (160.49)	170 x 170 x 91 (6.69 x 6.69 x 3.58)	JBEP171709NE57

ATX™ JBEP Series FRP Terminal Junction Boxes for Electrical and Power Applications

Increased Safety. Factory Drilled and Equipped.

ATEX/IECEX: Zones 1 and 2 – 21 and 22
 Notable: INMETRO Certified

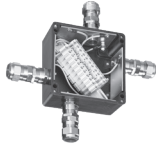

JBEP171709AE61

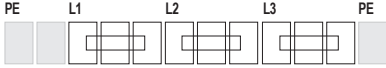
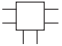
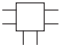

Ex eb IIC Factory Drilled JBEP Polyester Junction Boxes Equipped with Screw Terminals and Earth Terminals

- 10 mm² terminals (WDU10) and earth terminals (WPE10), 30 Amps maximum for 10 mm², 24 Amps max for 6 mm², 440 Volts

Enclosure Type	Equipment	Entry Layout	Weight kg (lb)	Volume dm ³ (in ³)	Dimensions - mm (in)	Terminal Jumped Catalog Number
Configuration: TP (2PE + 3L1 + 3L2 + 3L3 + 1PE) 						
JBEP1717090	6 x M25 with earth continuity device		1.60 (3.60)	2.63 (160.49)	170 x 170 x 91 (6.69 x 6.69 x 3.58)	JBEP171709AE58
JBEP1717090	6 x M25 with six cable glands for unarmored cable Diameter 8 to 17 mm (0.31 to 0.67 in)		1.60 (3.60)	2.63 (160.49)	170 x 170 x 91 (6.69 x 6.69 x 3.58)	JBEP171709NE58

Ex eb IIC Factory Drilled JBEP Polyester Junction Boxes Equipped with Screw Terminals and Earth Terminals

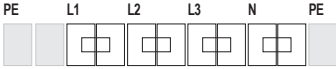
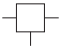
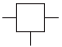
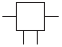
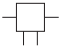
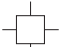
- 10 mm² terminals (WDU10) and earth terminals (WPE10), 30 Amps maximum for 10 mm², 26 Amps max for 6 mm², 440 Volts

Enclosure Type	Equipment	Entry Layout	Weight kg (lb)	Volume dm ³ (in ³)	Dimensions - mm (in)	Terminal Jumped Catalog Number
Configuration: TP + N (2PE + 2L1 + 2L2 + 2L3 + 2N + 1PE) 						
JBEP1717090	3 x M25 with earth continuity device		1.60 (3.60)	2.63 (160.49)	170 x 170 x 91 (6.69 x 6.69 x 3.58)	JBEP171709AE59
JBEP1717090	3 x M32 with three cable glands for unarmored cable Diameter 10 to 25 mm (0.39 to 0.98 in)		1.60 (3.60)	2.63 (160.49)	170 x 170 x 91 (6.69 x 6.69 x 3.58)	JBEP171709NE59
JBEP1717090	4 x M25 with earth continuity device		1.60 (3.60)	2.63 (160.49)	170 x 170 x 91 (6.69 x 6.69 x 3.58)	JBEP171709AE60
JBEP1717090	4 x M32 with four cable glands for unarmored cable Diameter 10 to 25 mm (0.39 to 0.98 in)		1.60 (3.60)	2.63 (160.49)	170 x 170 x 91 (6.69 x 6.69 x 3.58)	JBEP171709NE60
JBEP1717090	4 x M25 with earth continuity device		1.60 (3.60)	2.63 (160.49)	170 x 170 x 91 (6.69 x 6.69 x 3.58)	JBEP171709AE61
JBEP1717090	4 x M32 with four cable glands for unarmored cable Diameter 10 to 25 mm (0.39 to 0.98 in)		1.60 (3.60)	2.63 (160.49)	170 x 170 x 91 (6.69 x 6.69 x 3.58)	JBEP171709NE61

Enclosures and Junction Boxes

ATX™ JBEP Series FRP Terminal Junction Boxes for Electrical and Power Applications

Increased Safety. Factory Drilled and Equipped.

ATEX/IECEX: Zones 1 and 2 – 21 and 22
 Notable: INMETRO Certified

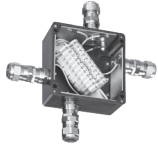

JBEP171709AE61

Ex eb IIC Factory Drilled JBEP Polyester Junction Boxes Equipped with Screw Terminals and Earth Terminals

- 10 mm² terminals (WDU10) and earth terminals (WPE10), 22 Amps maximum for 10 mm², 17 Amps max for 6 mm², 440 Volts

Enclosure Type	Equipment	Entry Layout	Weight kg (lb)	Volume dm ³ (in ³)	Dimensions - mm (in)	Terminal Jumped Catalog Number	
						PE	N
Configuration: TP + N (2PE + 3L1 + 3L2 + 3L3 + 3N + 1PE)							
JBEP2021100	6 x M25 with earth continuity device		2.10 (4.60)	4.09 (249.28)	200 x 215 x 95 (7.87 x 8.46 x 3.74)	JBEP202110AE62	
JBEP2021100	6 x M32 with six cable glands for unarmored cable Diameter 10 to 25 mm (0.39 to 0.98 in)		2.10 (4.60)	4.09 (249.28)	200 x 215 x 95 (7.87 x 8.46 x 3.74)	JBEP202110NE62	

ATX™ JBEP Series FRP Terminal Junction Boxes for Electrical and Power Applications

Increased Safety. Factory Drilled and Equipped.

ATEX/IECEX: Zones 1 and 2 – 21 and 22
 Notable: INMETRO Certified



JBEP202115AP06

Ex eb IIC Factory Drilled JBEP Polyester Junction Boxes Equipped with Screw Terminals, Earth Terminals and Earth Stud

- 16 mm² terminals (WDU16) and earth terminals (WPE16), 41 Amps maximum for 16 mm² and 10 mm², 440 Volts

Enclosure Type	Equipment	Entry Layout	Weight kg (lb)	Volume dm ³ (in ³)	Dimensions - mm (in)	Terminal Jumped Catalog Number				
						PE	L	N	PE	
Configuration: P + N (1PE + 2L + 2N + 2PE)										
JBEP2021150	3 x M25 with earth continuity device		4.00 (8.80)	6.45 (393.60)	200 x 215 x 145 (7.87 x 8.46 x 5.71)	JBEP202115AP01				
JBEP2021150	3 x M25 with three cable glands for unarmored cable Diameter 8 to 17 mm (0.31 to 0.67 in)		4.00 (8.80)	6.45 (393.60)	200 x 215 x 145 (7.87 x 8.46 x 5.71)	JBEP202115NP01				
JBEP2021150	4 x M25 with earth continuity device		4.00 (8.80)	6.45 (393.60)	200 x 215 x 145 (7.87 x 8.46 x 5.71)	JBEP202115AP02				
JBEP2021150	4 x M25 with four cable glands for unarmored cable Diameter 8 to 17 mm (0.31 to 0.67 in)		4.00 (8.80)	6.45 (393.60)	200 x 215 x 145 (7.87 x 8.46 x 5.71)	JBEP202115NP02				
JBEP2021150	4 x M25 with earth continuity device		4.00 (8.80)	6.45 (393.60)	200 x 215 x 145 (7.87 x 8.46 x 5.71)	JBEP202115AP03				
JBEP2021150	4 x M25 with four cable glands for unarmored cable Diameter 8 to 17 mm (0.31 to 0.67 in)		4.00 (8.80)	6.45 (393.60)	200 x 215 x 145 (7.87 x 8.46 x 5.71)	JBEP202115NP03				
JBEP2021150	4 x M25 with earth continuity device		4.00 (8.80)	6.45 (393.60)	200 x 215 x 145 (7.87 x 8.46 x 5.71)	JBEP202115AP04				
JBEP2021150	4 x M25 with four cable glands for unarmored cable Diameter 8 to 17 mm (0.31 to 0.67 in)		4.00 (8.80)	6.45 (393.60)	200 x 215 x 145 (7.87 x 8.46 x 5.71)	JBEP202115NP04				

Ex eb IIC Factory Drilled JBEP Polyester Junction Boxes Equipped with Screw Terminals, Earth Terminals and Earth Stud

- 16 mm² terminals (WDU16) and earth terminals (WPE16), 41 Amps maximum for 16 mm² and 10 mm², 440 Volts

Enclosure Type	Equipment	Entry Layout	Weight kg (lb)	Volume dm ³ (in ³)	Dimensions - mm (in)	Terminal Jumped Catalog Number				
						PE	L1	N	PE	
Configuration: P + N (2PE + 3L + 3N + 2PE)										
JBEP2021150	6 x M25 with earth continuity device		4.00 (8.80)	6.45 (393.60)	200 x 215 x 145 (7.87 x 8.46 x 5.71)	JBEP202115AP05				
JBEP2021150	6 x M25 with six cable glands for unarmored cable Diameter 8 to 17 mm (0.31 to 0.67 in)		4.00 (8.80)	6.45 (393.60)	200 x 215 x 145 (7.87 x 8.46 x 5.71)	JBEP202115NP05				
JBEP2021150	6 x M25 with earth continuity device		4.00 (8.80)	6.45 (393.60)	200 x 215 x 145 (7.87 x 8.46 x 5.71)	JBEP202115AP06				
JBEP2021150	6 x M25 with six cable glands for unarmored cable Diameter 8 to 17 mm (0.31 to 0.67 in)		4.00 (8.80)	6.45 (393.60)	200 x 215 x 145 (7.87 x 8.46 x 5.71)	JBEP202115NP06				

Enclosures and Junction Boxes

ATX™ JBEP Series FRP Terminal Junction Boxes for Electrical and Power Applications

Increased Safety. Factory Drilled and Equipped.

ATEX/IECEx: Zones 1 and 2 – 21 and 22
 Notable: INMETRO Certified



JBEP202115AP12

Ex eb IIC Factory Drilled JBEP Polyester Junction Boxes Equipped with Screw Terminals, Earth Terminals and Earth Stud

- 16 mm² terminals (WDU16) and earth terminals (WPE16), 41 Amps maximum for 16 mm² and 10 mm², 440 Volts

Enclosure Type	Equipment	Entry Layout	Weight kg (lb)	Volume dm ³ (in ³)	Dimensions - mm (in)	Terminal Jumped Catalog Number				
						PE	L1	L2	L3	PE
Configuration: TP (1PE + 2L1 + 2L2 + 2L3 + 2PE)										
JBEP2021150	3 x M25 with earth continuity device		4.00 (8.80)	6.45 (393.60)	200 x 215 x 145 (7.87 x 8.46 x 5.71)	JBEP202115AP07				
JBEP2021150	3 x M25 with three cable glands for unarmored cable Diameter 8 to 17 mm (0.31 to 0.67 in)		4.00 (8.80)	6.45 (393.60)	200 x 215 x 145 (7.87 x 8.46 x 5.71)	JBEP202115NP07				
JBEP2021150	4 x M25 with earth continuity device		4.00 (8.80)	6.45 (393.60)	200 x 215 x 145 (7.87 x 8.46 x 5.71)	JBEP202115AP08				
JBEP2021150	4 x M25 with four cable glands for unarmored cable Diameter 8 to 17 mm (0.31 to 0.67 in)		4.00 (8.80)	6.45 (393.60)	200 x 215 x 145 (7.87 x 8.46 x 5.71)	JBEP202115NP08				
JBEP2021150	4 x M25 with earth continuity device		4.00 (8.80)	6.45 (393.60)	200 x 215 x 145 (7.87 x 8.46 x 5.71)	JBEP202115AP09				
JBEP2021150	4 x M25 with four cable glands for unarmored cable Diameter 8 to 17 mm (0.31 to 0.67 in)		4.00 (8.80)	6.45 (393.60)	200 x 215 x 145 (7.87 x 8.46 x 5.71)	JBEP202115NP09				
JBEP2021150	4 x M25 with earth continuity device		4.00 (8.80)	6.45 (393.60)	200 x 215 x 145 (7.87 x 8.46 x 5.71)	JBEP202115AP10				
JBEP2021150	4 x M25 with four cable glands for unarmored cable Diameter 8 to 17 mm (0.31 to 0.67 in)		4.00 (8.80)	6.45 (393.60)	200 x 215 x 145 (7.87 x 8.46 x 5.71)	JBEP202115NP10				

Ex eb IIC Factory Drilled JBEP Polyester Junction Boxes Equipped with Screw Terminals, Earth Terminals and Earth Stud

- 16 mm² terminals (WDU16) and earth terminals (WPE16), 41 Amps maximum for 16 mm², 38 Amps maximum for 10 mm², 440 Volts

Enclosure Type	Equipment	Entry Layout	Weight kg (lb)	Volume dm ³ (in ³)	Dimensions - mm (in)	Terminal Jumped Catalog Number				
						PE	L1	L2	L3	PE
Configuration: TP (2PE + 3L1 + 3L2 + 3L3 + 2PE)										
JBEP2021150	6 x M25 with earth continuity device		4.00 (8.80)	6.45 (393.60)	200 x 215 x 145 (7.87 x 8.46 x 5.71)	JBEP202115AP11				
JBEP2021150	6 x M25 with six cable glands for unarmored cable Diameter 8 to 17 mm (0.31 to 0.67 in)		4.00 (8.80)	6.45 (393.60)	200 x 215 x 145 (7.87 x 8.46 x 5.71)	JBEP202115NP11				
JBEP2021150	6 x M25 with earth continuity device		4.00 (8.80)	6.45 (393.60)	200 x 215 x 145 (7.87 x 8.46 x 5.71)	JBEP202115AP12				
JBEP2021150	6 x M25 with six cable glands for unarmored cable Diameter 8 to 17 mm (0.31 to 0.67 in)		4.00 (8.80)	6.45 (393.60)	200 x 215 x 145 (7.87 x 8.46 x 5.71)	JBEP202115NP12				

ATX™ JBEP Series FRP Terminal Junction Boxes for Electrical and Power Applications

Increased Safety. Factory Drilled and Equipped.

ATEX/IECEx: Zones 1 and 2 – 21 and 22
 Notable: INMETRO Certified

Ex eb IIC Factory Drilled JBEP Polyester Junction Boxes Equipped with Screw Terminals, Earth Terminals and Earth Stud

• 16 mm² terminals (WDU16) and earth terminals (WPE16), 41 Amps maximum for 16 mm², 40 Amps maximum for 10 mm², 440 Volts

Enclosure Type	Equipment	Entry Layout	Weight kg (lb)	Volume dm ³ (in ³)	Dimensions - mm (in)	Terminal Jumped Catalog Number					
						PE	L1	L2	L3	N	PE
Configuration: TP + N (2PE + 2L1 + 2L2 + 2L3 + 2N + PE)											
JBEP2021150	3 x M25 with earth continuity device		4.00 (8.80)	6.45 (393.60)	200 x 215 x 145 (7.87 x 8.46 x 5.71)	JBEP202115AP13					
JBEP2021150	3 x M32 with three cable glands for unarmored cable Diameter 10 to 25 mm (0.39 to 0.98 in)		4.00 (8.80)	6.45 (393.60)	200 x 215 x 145 (7.87 x 8.46 x 5.71)	JBEP202115NP13					
JBEP2021150	4 x M25 with earth continuity device		4.00 (8.80)	6.45 (393.60)	200 x 215 x 145 (7.87 x 8.46 x 5.71)	JBEP202115AP14					
JBEP2021150	4 x M32 with four cable glands for unarmored cable Diameter 10 to 25 mm (0.39 to 0.98 in)		4.00 (8.80)	6.45 (393.60)	200 x 215 x 145 (7.87 x 8.46 x 5.71)	JBEP202115NP14					
JBEP2021150	4 x M25 with earth continuity device		4.00 (8.80)	6.45 (393.60)	200 x 215 x 145 (7.87 x 8.46 x 5.71)	JBEP202115AP15					
JBEP2021150	4 x M32 with four cable glands for unarmored cable Diameter 10 to 25 mm (0.39 to 0.98 in)		4.00 (8.80)	6.45 (393.60)	200 x 215 x 145 (7.87 x 8.46 x 5.71)	JBEP202115NP15					
JBEP2021150	4 x M25 with earth continuity device		4.00 (8.80)	6.45 (393.60)	200 x 215 x 145 (7.87 x 8.46 x 5.71)	JBEP202115AP16					
JBEP2021150	4 x M32 with four cable glands for unarmored cable Diameter 10 to 25 mm (0.39 to 0.98 in)		4.00 (8.80)	6.45 (393.60)	200 x 215 x 145 (7.87 x 8.46 x 5.71)	JBEP202115NP16					

Ex eb IIC Factory Drilled JBEP Polyester Junction Boxes Equipped with Screw Terminals, Earth Terminals and Earth Stud

• 16 mm² terminals (WDU16) and earth terminals (WPE16), 34 Amps maximum for 16 mm², 28 Amps maximum for 10 mm², 440 Volts

Enclosure Type	Equipment	Entry Layout	Weight kg (lb)	Volume dm ³ (in ³)	Dimensions - mm (in)	Terminal Jumped Catalog Number					
						PE	L1	L2	L3	N	PE
Configuration: TP + N (2PE + 3L1 + 3L2 + 3L3 + 3N + 2PE)											
JBEP2532150	6 x M25 with earth continuity device		8.20 (18.00)	12.00 (732.28)	250 x 320 x 150 (9.84 x 12.60 x 5.94)	JBEP253215AP17					
JBEP2532150	6 x M32 with six cable glands for unarmored cable Diameter 10 to 25 mm (0.39 to 0.98 in)		8.20 (18.00)	12.00 (732.28)	250 x 320 x 150 (9.84 x 12.60 x 5.94)	JBEP253215NP17					
JBEP2532150	6 x M25 with earth continuity device		8.20 (18.00)	12.00 (732.28)	250 x 320 x 150 (9.84 x 12.60 x 5.94)	JBEP253215AP18					
JBEP2532150	6 x M32 with six cable glands for unarmored cable Diameter 10 to 25 mm (0.39 to 0.98 in)		8.20 (18.00)	12.00 (732.28)	250 x 320 x 150 (9.84 x 12.60 x 5.94)	JBEP253215NP18					

Enclosures and Junction Boxes

ATX™ JBEP Series FRP Terminal Junction Boxes for Electrical and Power Applications

Increased Safety. Factory Drilled and Equipped.

ATEX/IECEx: Zones 1 and 2 – 21 and 22
 Notable: INMETRO Certified



JBEP253215NP02

Ex eb IIC Factory Drilled JBEP Polyester Junction Boxes Equipped with Screw Terminals, Earth Terminals and Earth Stud

- 35 mm² terminals (WDU35) and earth terminals (WPE35), 54 Amps maximum for 35 mm² and 25 mm², 440 Volts

Enclosure Type	Equipment	Entry Layout	Weight kg (lb)	Volume dm ³ (in ³)	Dimensions - mm (in)	Terminal Jumped Catalog Number
Configuration: TP (1PE + 2L1 + 2L2 + 2L3 + 2PE)						
JBEP2532150	4 x M32 with earth continuity device		8.20 (18.00)	12.00 (732.28)	250 x 320 x 151 (9.84 x 12.60 x 5.94)	JBEP253215AP01
JBEP2532150	4 x M32 with four cable glands for unarmored cable Diameter 10 to 25 mm (0.39 to 0.98 in)		8.20 (18.00)	12.00 (732.28)	250 x 320 x 151 (9.84 x 12.60 x 5.94)	JBEP253215NP01

Ex eb IIC Factory Drilled JBEP Polyester Junction Boxes Equipped with Screw Terminals, Earth Terminals and Earth Stud

- 35 mm² terminals (WDU35) and earth terminals (WPE35), 54 Amps maximum for 35 mm², 48 Amps maximum for 25 mm², 440 Volts

Enclosure Type	Equipment	Entry Layout	Weight kg (lb)	Volume dm ³ (in ³)	Dimensions - mm (in)	Terminal Jumped Catalog Number
Configuration: TP (2PE + 3L1 + 3L2 + 3L3 + 2PE)						
JBEP2532150	6 x M32 with earth continuity device		8.20 (18.00)	12.00 (732.28)	250 x 320 x 151 (9.84 x 12.60 x 5.94)	JBEP253215AP02
JBEP2532150	6 x M32 with six cable glands for unarmored cable Diameter 10 to 25 mm (0.39 to 0.98 in)		8.20 (18.00)	12.00 (732.28)	250 x 320 x 151 (9.84 x 12.60 x 5.94)	JBEP253215NP02

ATX™ JBEP Series FRP Terminal Junction Boxes for Electrical and Power Applications

Increased Safety. Factory Drilled and Equipped.

ATEX/IECEX: Zones 1 and 2 – 21 and 22
 Notable: INMETRO Certified



JBEP253215NP04

Ex eb IIC Factory Drilled JBEP Polyester Junction Boxes Equipped with Screw Terminals, Earth Terminals and Earth Stud

- 35 mm² terminals (WDU35) and earth terminals (WPE35), 54 Amps maximum for 35 mm², 51 Amps maximum for 25 mm², 440 Volts

Enclosure Type	Equipment	Entry Layout	Weight kg (lb)	Volume dm ³ (in ³)	Dimensions - mm (in)	Terminal Jumped Catalog Number					
						PE	L1	L2	L3	N	PE
Configuration: TP + N (2PE + 2L1 + 2L2 + 2L3 + 2N + PE)											
JBEP2532150	4 x M32 with earth continuity device		8.20 (18.00)	12.00 (732.28)	250 x 320 x 150 (9.84 x 12.60 x 5.91)	JBEP253215AP03					
JBEP2532150	4 x M32 with four cable glands for unarmored cable Diameter 10 to 25 mm (0.39 to 0.98 in)		8.20 (18.00)	12.00 (732.28)	250 x 320 x 150 (9.84 x 12.60 x 5.91)	JBEP253215NP03					

Ex eb IIC Factory Drilled JBEP Polyester Junction Boxes Equipped with Screw Terminals, Earth Terminals and Earth Stud

- 35 mm² terminals (WDU35) and earth terminals (WPE35), 47 Amps maximum for 35 mm², 42 Amps maximum for 25 mm², 440 Volts

Enclosure Type	Equipment	Entry Layout	Weight kg (lb)	Volume dm ³ (in ³)	Dimensions - mm (in)	Terminal Jumped Catalog Number					
						PE	L1	L2	L3	N	PE
Configuration: TP + N (2PE + 3L1 + 3L2 + 3L3 + 3N + 2PE)											
JBEP2532150	6 x M32 with earth continuity device		8.20 (18.00)	12.00 (732.28)	250 x 320 x 150 (9.84 x 12.60 x 5.91)	JBEP253215AP04					
JBEP2532150	6 x M40 with six cable glands for unarmored cable Diameter 24 to 34 mm (0.94 to 1.34 in)		8.20 (18.00)	12.00 (732.28)	250 x 320 x 150 (9.84 x 12.60 x 5.91)	JBEP253215NP04					

Enclosures and Junction Boxes

ATX™ JBEP Series FRP Terminal Junction Boxes for Electrical and Power Applications

Increased Safety. Factory Drilled and Equipped.

ATEX/IECEx: Zones 1 and 2 – 21 and 22
 Notable: INMETRO Certified



JBEP503215AP02

Ex eb IIC Factory Drilled JBEP Polyester Junction Boxes Equipped with Screw Terminals, Earth Terminals and Earth Stud

- 50 mm² terminals (WDU50N) and earth terminals (WPE35), 58 Amps maximum for 50 mm² and 35 mm², 440 Volts

Enclosure Type	Equipment	Entry Layout	Weight kg (lb)	Volume dm ³ (in ³)	Dimensions - mm (in)	Terminal Jumped Catalog Number
Configuration: TP (1PE + 2L1 + 2L2 + 2L3 + 2PE)						
JBEP5032150	4 x M40 with earth continuity device		8.50 (18.60)	24.00 (1464.57)	500 x 320 x 150 (19.68 x 12.60 x 5.91)	JBEP503215AP01
JBEP5032150	4 x M40 with four cable glands for unarmored cable Diameter 24 to 34 mm (0.94 to 1.34 in)		8.50 (18.60)	24.00 (1464.57)	500 x 320 x 150 (19.68 x 12.60 x 5.91)	JBEP503215NP01

Ex eb IIC Factory Drilled JBEP Polyester Junction Boxes Equipped with Screw Terminals, Earth Terminals and Earth Stud

- 50 mm² terminals (WDU50N) and earth terminals (WPE35), 58 Amps maximum for 50 mm² and 35 mm², 440 Volts

Enclosure Type	Equipment	Entry Layout	Weight kg (lb)	Volume dm ³ (in ³)	Dimensions - mm (in)	Terminal Jumped Catalog Number
Configuration: TP (2PE + 3L1 + 3L2 + 3L3 + 2PE)						
JBEP5032150	6 x M40 with earth continuity device		8.50 (18.60)	24.00 (1464.57)	500 x 320 x 150 (19.68 x 12.60 x 5.91)	JBEP503215AP02
JBEP5032150	6 x M40 with six cable glands for unarmored cable Diameter 24 to 34 mm (0.94 to 1.34 in)		8.50 (18.60)	24.00 (1464.57)	500 x 320 x 150 (19.68 x 12.60 x 5.91)	JBEP503215NP02

Enclosures and Junction Boxes

ATX™ JBEP Series FRP Terminal Junction Boxes for Electrical and Power Applications

Increased Safety. Factory Drilled and Equipped.

ATEX/IECEx: Zones 1 and 2 – 21 and 22
 Notable: INMETRO Certified



JBEP503215AP04

Ex eb IIC Factory Drilled JBEP Polyester Junction Boxes Equipped with Screw Terminals, Earth Terminals and Earth Stud

- 50 mm² terminals (WDU50N) and earth terminals (WPE35), 58 Amps maximum for 50 mm² and 35 mm², 440 Volts

Enclosure Type	Equipment	Entry Layout	Weight kg (lb)	Volume dm ³ (in ³)	Dimensions - mm (in)	Terminal Jumped Catalog Number						
						PE	L1	L2	L3	N	PE	
Configuration: TP + N (2PE + 2L1 + 2L2 + 2L3 + 2N + PE)												
JBEP5032150	4 x M40 with earth continuity device		8.50 (18.60)	24.00 (1464.57)	500 x 320 x 150 (19.68 x 12.60 x 5.91)							JBEP503215AP03
JBEP5032150	4 x M40 with four cable glands for unarmored cable Diameter 24 to 34 mm (0.94 to 1.34 in)		8.50 (18.60)	24.00 (1464.57)	500 x 320 x 150 (19.68 x 12.60 x 5.91)							JBEP503215NP03

Ex eb IIC Factory Drilled JBEP Polyester Junction Boxes Equipped with Screw Terminals, Earth Terminals and Earth Stud

- 50 mm² terminals (WDU50N) and earth terminals (WPE35), 58 Amps maximum for 50 mm², 54 Amps maximum for 35 mm², 440 Volts

Enclosure Type	Equipment	Entry Layout	Weight kg (lb)	Volume dm ³ (in ³)	Dimensions - mm (in)	Terminal Jumped Catalog Number						
						PE	L1	L2	L3	N	PE	
Configuration: TP + N (2PE + 3L1 + 3L2 + 3L3 + 3N + 2PE)												
JBEP5032150	6 x M40 with earth continuity device		9.30 (20.50)	24.00 (1464.57)	500 x 320 x 150 (19.68 x 12.60 x 5.91)							JBEP503215AP04
JBEP5032230	6 x M50 with six cable glands for unarmored cable Diameter 28 to 42 mm (1.10 to 1.65 in)		10.30 (22.70)	36.80 (2245.67)	500 x 320 x 230 (19.68 x 12.60 x 9.06)							JBEP503223NP04

Enclosures and Junction Boxes

ATX™ JBEP Series FRP Terminal Junction Boxes for Electrical and Power Applications

Increased Safety. Factory Drilled and Equipped.

ATEX/IECEx: Zones 1 and 2 – 21 and 22
 Notable: INMETRO Certified



JBEP503215AP22

Ex eb IIC Factory Drilled JBEP Polyester Junction Boxes Equipped with Screw Terminals, Earth Terminals and Earth Stud

- 70 mm² terminals (WDU70N) and earth terminals (WPE35), 84 Amps maximum for 70 mm² and 50 mm², 440 Volts

Enclosure Type	Equipment	Entry Layout	Weight kg (lb)	Volume dm ³ (in ³)	Dimensions - mm (in)	Terminal Jumped Catalog Number				
						PE	L1	L2	L3	PE
Configuration: TP (1PE + 2L1 + 2L2 + 2L3 + 2PE)										
JBEP5032150	4 x M40 with earth continuity device		9.30 (20.50)	24.00 (1464.57)	500 x 320 x 150 (19.68 x 12.60 x 5.91)	JBEP503215AP21				
JBEP5032150	4 x M40 with four cable glands for unarmored cable Diameter 24 to 34 mm (0.94 to 1.34 in)		9.30 (20.50)	24.00 (1464.57)	500 x 320 x 150 (19.68 x 12.60 x 5.91)	JBEP503215NP21				

Ex eb IIC Factory Drilled JBEP Polyester Junction Boxes Equipped with Screw Terminals, Earth Terminals and Earth Stud

- 70 mm² terminals (WDU70N) and earth terminals (WPE35), 79 Amps maximum for 70 mm², 72 Amps maximum for 50 mm², 440 Volts

Enclosure Type	Equipment	Entry Layout	Weight kg (lb)	Volume dm ³ (in ³)	Dimensions - mm (in)	Terminal Jumped Catalog Number ②				
						PE	L1	L2	L3	PE
Configuration: TP (2PE + 3L1 + 3L2 + 3L3 + 2PE)										
JBEP5032150	6 x M40 with earth continuity device		9.30 (20.50)	24.00 (1464.57)	500 x 320 x 150 (19.68 x 12.60 x 5.91)	JBEP503215AP22				
JBEP5032150	6 x M40 with six cable glands for unarmored cable Diameter 24 to 34 mm (0.94 to 1.34 in)		9.30 (20.50)	24.00 (1464.57)	500 x 320 x 150 (19.68 x 12.60 x 5.91)	JBEP503215NP22				

ATX™ JBEP Series FRP Terminal Junction Boxes for Electrical and Power Applications

Increased Safety. Factory Drilled and Equipped.

ATEX/IECEx: Zones 1 and 2 – 21 and 22
 Notable: INMETRO Certified



JBEP503215AP24

Ex eb IIC Factory Drilled JBEP Polyester Junction Boxes Equipped with Screw Terminals, Earth Terminals and Earth Stud

- 70 mm² terminals (WDU70N) and earth terminals (WPE35), 84 Amps maximum for 70 mm², 77 Amps maximum for 50 mm², 440 Volts

Enclosure Type	Equipment	Entry Layout	Weight kg (lb)	Volume dm ³ (in ³)	Dimensions - mm (in)	Terminal Jumped Catalog Number ②						
						PE	L1	L2	L3	N	PE	
Configuration: TP + N (2PE + 2L1 + 2L2 + 2L3 + 2N + PE)												
JBEP5032150	4 x M40 with earth continuity device		9.30 (20.50)	24.00 (1464.57)	500 x 320 x 150 (19.68 x 12.60 x 5.91)							JBEP503215AP23
JBEP5032150	4 x M40 with four cable glands for unarmored cable Diameter 24 to 34 mm (0.94 to 1.34 in)		9.30 (20.50)	24.00 (1464.57)	500 x 320 x 150 (19.68 x 12.60 x 5.91)							JBEP503215NP23

Ex eb IIC Factory Drilled JBEP Polyester Junction Boxes Equipped with Screw Terminals, Earth Terminals and Earth Stud

- 70 mm² terminals (WDU70N) and earth terminals (WPE35), 68 Amps maximum for 70 mm², 62 Amps maximum for 50 mm², 440 Volts

Enclosure Type	Equipment	Entry Layout	Weight kg (lb)	Volume dm ³ (in ³)	Dimensions - mm (in)	Terminal Jumped Catalog Number						
						PE	L1	L2	L3	N	PE	
Configuration: TP + N (2PE + 3L1 + 3L2 + 3L3 + 3N + 2PE)												
JBEP5032150	6 x M40 with earth continuity device		9.30 (20.50)	24.00 (1464.57)	500 x 320 x 150 (19.68 x 12.60 x 5.91)							JBEP503215AP24
JBEP5032230	6 x M50 with six cable glands for unarmored cable Diameter 28 to 42 mm (1.10 to 1.65 in)		10.30 (22.70)	36.80 (2245.67)	500 x 320 x 230 (19.68 x 12.60 x 9.06)							JBEP503223NP24

Enclosures and Junction Boxes

ATX™ JBEP Series FRP Terminal Junction Boxes for Electrical and Power Applications

Increased Safety. Factory Drilled and Equipped.

ATEX/IECEX: Zones 1 and 2 – 21 and 22
 Notable: INMETRO Certified

Ex eb IIC Factory Drilled JBEP Polyester Junction Boxes Equipped with Screw Terminals, Earth Bar and Earth Stud

- 120 mm² terminals (WDU95N/120N) and earth copper bar

Enclosure Type	Equipment	Entry Layout	Weight kg (lb)	Volume dm ³ (in ³)	Dimensions - mm (in)	Terminal Jumped Catalog Number
						<p>Earth Copper Bar PE</p>
Configuration: TP (2L1 + 2L2 + 2L3 + 1PE) • 95 Amps maximum for 120 mm ² and 95 mm ² , 440 Volts						
JBEP7532230	4 x M50 with earth continuity device		10.80 (23.80)	55.20 (3368.51)	750 x 320 x 230 (29.53 x 12.60 x 9.06)	JBEP753223AP01
JBEP7532150	4 x M50 with four cable glands for unarmored cable Diameter 28 to 42 mm (1.10 to 1.65 in)		9.75 (21.50)	36.00 (2196.85)	750 x 320 x 150 (29.53 x 12.60 x 5.91)	JBEP753215NP01
						<p>Earth Copper Bar PE</p>
Configuration: TP (3L1 + 3L2 + 3L3 + 1PE) • 91 Amps maximum for 120 mm ² , 86 Amps maximum for 95 mm ² , 440 Volts						
JBEP7532230	6 x M50 with earth continuity device		10.80 (23.80)	55.20 (3368.51)	750 x 320 x 230 (29.53 x 12.60 x 9.06)	JBEP753223AP02
JBEP7532230	6 x M50 with six cable glands for unarmored cable Diameter 28 to 42 mm (1.10 to 1.65 in)		10.80 (23.80)	55.20 (3368.51)	750 x 320 x 230 (29.53 x 12.60 x 9.06)	JBEP753223NP02
						<p>Earth Copper Bar PE</p>
Configuration: TP + N (2L1 + 2L2 + 2L3 + 2N + 1PE) • 95 Amps maximum for 120 mm ² , 91 Amps maximum for 95 mm ² , 440 Volts						
JBEP7532230	4 x M50 with earth continuity device		10.80 (23.80)	55.20 (3368.51)	750 x 320 x 230 (29.53 x 12.60 x 9.06)	JBEP753223AP03
JBEP7532150	4 x M50 with four cable glands for unarmored cable Diameter 28 to 42 mm (1.10 to 1.65 in)		9.75 (21.50)	36.00 (2196.85)	750 x 320 x 150 (29.53 x 12.60 x 5.91)	JBEP753215NP03

ATX™ JBEP Series FRP Terminal Junction Boxes for Electrical and Power Applications

Increased Safety. Factory Drilled and Equipped.

ATEX/IECEx: Zones 1 and 2 – 21 and 22
 Notable: INMETRO Certified

Dimensions in Millimeters (Inches) ①

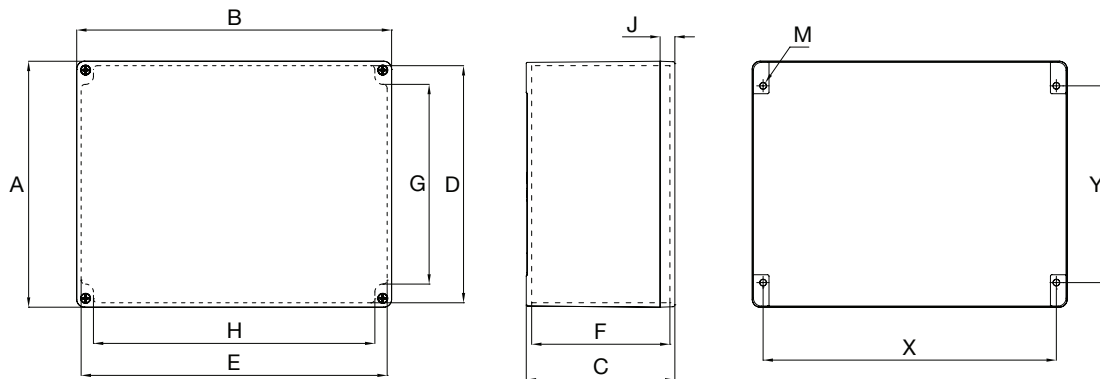

Enclosure Catalog Number	External Dimension		Internal Dimensions					Cover	Body Thickness	Wall Fixing		M ②	
	A	B	C	D	E	F	G			H	J		X
JBEP0808060	85.0 (3.346)	85.0 (3.346)	61.0 (2.402)	76.7 (3.020)	76.7 (3.020)	47.0 (1.850)	41.0 (1.614)	51.0 (2.008)	15.0 (0.591)	3.5 (0.138)	69.0 (2.717)	49.0 (1.929)	M4
JBEP121209S0	120.0 (4.724)	120.0 (4.724)	91.0 (3.583)	109.5 (4.311)	109.5 (4.311)	75.0 (2.953)	63.0 (4.528)	85.0 (3.346)	15.0 (0.591)	4.5 (0.177)	103.0 (4.055)	83.0 (3.268)	M5
JBEP1717090	170.0 (6.693)	170.0 (6.693)	91.0 (3.583)	158.5 (6.240)	158.5 (6.240)	72.0 (2.835)	112.5 (4.429)	137.0 (5.394)	15.0 (0.591)	4.5 (0.177)	153.0 (6.024)	131.0 (5.157)	M5
JBEP2021100	200.0 (7.874)	215.0 (8.465)	95.0 (3.740)	185.8 (7.315)	200.8 (7.906)	76.0 (2.992)	116.0 (4.567)	159.0 (6.260)	20.0 (0.787)	6.1 (0.240)	189.0 (7.441)	146.0 (5.748)	M6
JBEP2021150	200.0 (7.874)	215.0 (8.465)	145.0 (5.709)	185.8 (7.315)	200.8 (7.906)	122.5 (4.823)	114.8 (4.519)	159.0 (6.260)	20.0 (0.787)	6.1 (0.240)	189.0 (7.441)	146.0 (5.748)	M6
JBEP2532150	250.0 (9.843)	320.0 (12.598)	150.0 (5.906)	241.0 (9.488)	311.0 (12.244)	133.5 (5.256)	171.0 (6.732)	267.0 (10.512)	15.0 (0.591)	5.0 (0.197)	200.0 (7.874)	298.0 (11.732)	M6
JBEP3225150	320.0 (12.598)	250.0 (9.843)	150.0 (5.906)	311.0 (12.244)	241.0 (9.488)	133.5 (5.256)	267.0 (10.512)	171.0 (6.732)	15.0 (0.591)	5.0 (0.197)	298.0 (11.732)	200.0 (7.874)	M6
JBEP3250150	320.0 (12.598)	500.0 (19.685)	150.0 (5.906)	311.0 (12.244)	491.0 (19.331)	133.5 (5.256)	267.0 (10.512)	421.0 (16.575)	15.0 (0.591)	5.0 (0.197)	298.0 (11.732)	447.0 (17.598)	M6
JBEP3250230	320.0 (12.598)	500.0 (19.685)	230.0 (9.055)	311.0 (12.244)	491.0 (19.331)	213.5 (8.406)	267.0 (10.512)	421.0 (16.575)	15.0 (0.591)	5.0 (0.197)	298.0 (11.732)	447.0 (17.598)	M6
JBEP3275150	320.0 (12.598)	750.0 (29.528)	150.0 (5.906)	311.0 (12.244)	741.0 (29.173)	133.5 (5.256)	267.0 (10.512)	671.0 (26.417)	15.0 (0.591)	5.0 (0.197)	298.0 (11.732)	698.0 (27.480)	M6
JBEP3275230	320.0 (12.598)	750.0 (29.528)	230.0 (9.055)	311.0 (12.244)	741.0 (29.173)	213.5 (8.406)	267.0 (10.512)	671.0 (26.417)	15.0 (0.591)	5.0 (0.197)	298.0 (11.732)	698.0 (27.480)	M6

① Wall fixing screw diameter 5 mm (0.20"). Wall fixing screw hole 6 mm (0.24").

② Screw to be used for mounting box.

ATX™ JBEP Series FRP Terminal Junction Boxes for Electrical and Power Applications

Increased Safety. Factory Drilled and Equipped.

ATEX/IECEX: Zones 1 and 2 – 21 and 22
 Notable: INMETRO Certified

Dimensions in Millimeters (Inches) ①

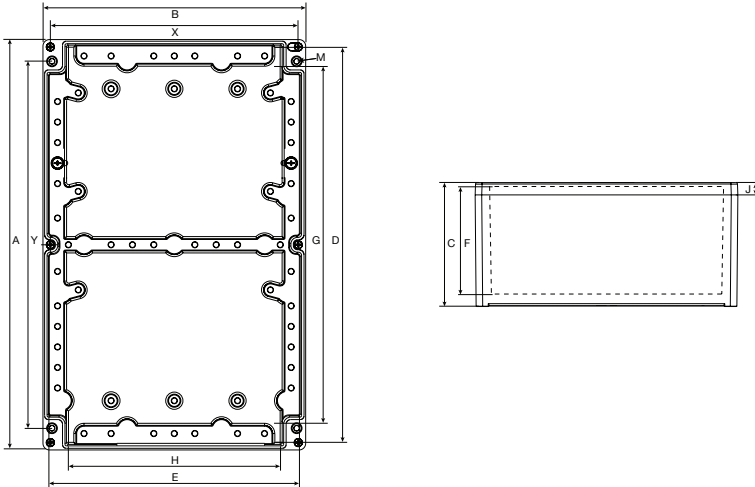

Enclosure Catalog Number	External Dimension			Internal Dimensions				Cover J	Body Thickness	Wall Fixing			
	A	B	C	D	E	F	G			H	X	Y	M ②
JBEP5032150	500 (19.685)	320 (12.598)	150 (5.906)	491 (19.331)	311 (12.244)	133.5 (5.256)	421 (16.575)	267 (10.512)	15 (0.591)	5 (0.197)	447 (17.598)	298 (11.732)	M6
JBEP5032230	500 (19.685)	320 (12.598)	230 (9.055)	491 (19.331)	311 (12.244)	213.5 (8.406)	421 (16.575)	267 (10.512)	15 (0.591)	5 (0.197)	447 (17.598)	298 (11.732)	M6
JBEP7532150	750 (29.528)	320 (12.598)	150 (5.906)	741 (29.173)	311 (12.244)	133.5 (5.256)	671 (26.417)	267 (10.512)	15 (0.591)	5 (0.197)	298 (11.732)	698 (27.480)	M6
JBEP7532230	750 (29.528)	320 (12.598)	230 (9.055)	741 (29.173)	311 (12.244)	213.5 (8.406)	671 (26.417)	267 (10.512)	15 (0.591)	5 (0.197)	698 (27.480)	298 (11.732)	M6

① Wall fixing screw diameter 5 mm (0.20"). Wall fixing screw hole 6 mm (0.24").

② Screw to be used for mounting box.